

NO.	GRANTOR	GRANTEE	INSTRUMENT	DATE	RECORD	CURT. NO.	REMARKS
1.			None				See Note 1

Note 1- Charter with claims under decisions of Tennessee Courts.  
 The road from Tullahoma to McMinnville, a distance of 35 miles, was constructed by the McMinnville and Manchester R.R.Co. about the year 1856. Under a Chancery decree dated July 10, 1875 this road was sold to the Memphis and Charleston R.R.Co. On July 25, 1877 the Memphis and Charleston R.R.Co. sold the road to the Nashville, Chattanooga & St. Louis Railway.



Cont. 49489 2-13-63 C.S. Kenner Const. Co. Arr. Rd. Xing at Sta. 863+06 C&O.

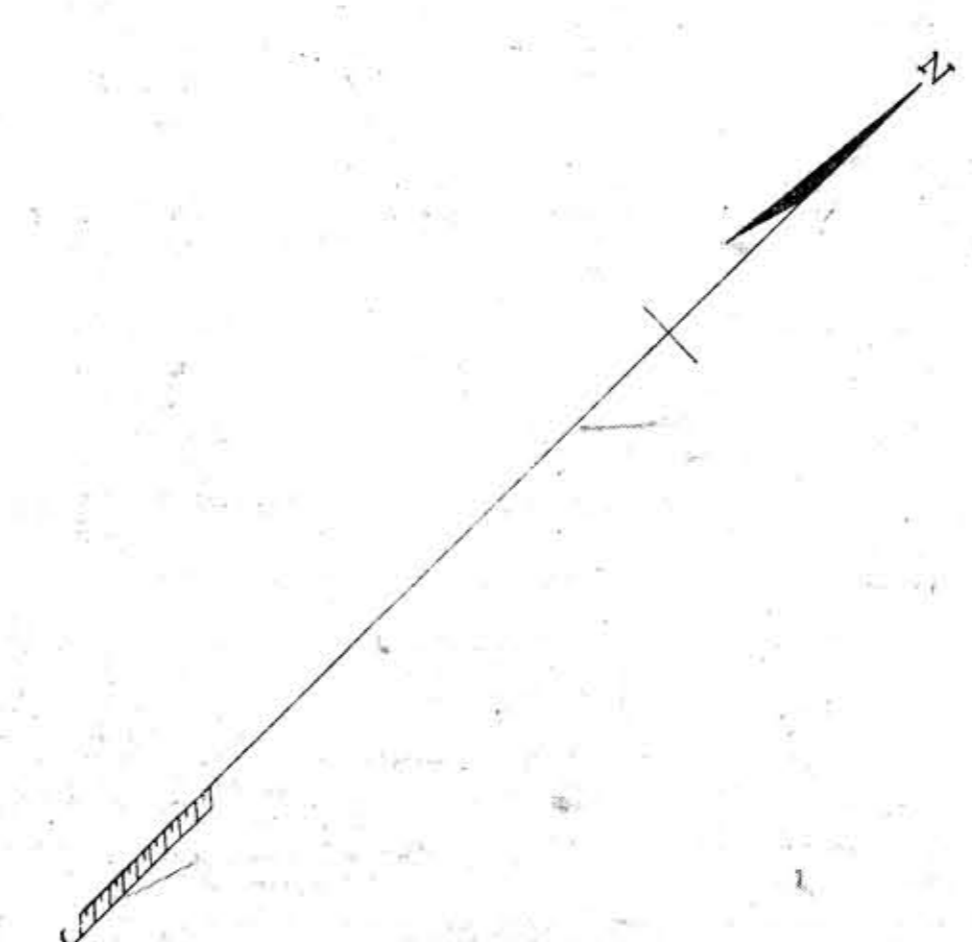

RIGHT-OF-WAY AND TRACK MAP  
 NASHVILLE, CHATTANOOGA AND ST. LOUIS RY.  
 SPARTA BRANCH  
 STATION 850+36 TO STATION 955+96  
 SCALE, 1 IN. = 200 FT. JUNE 30, 1916  
 OFFICE OF CHIEF ENGINEER  
 NASHVILLE, TENN.  
 M.P. 16.2 to 18.2

016-009

Sheet No. 9 of 44 Sheets of  
 Sparta Branch from survey  
 station 850+36 to survey station  
 955+96  
 Valuation Engineer

Coffee Co. Tenn.